

3/1/06

REVISED

SHEETING NOTES:

1. SHEETING AND SHORING SYSTEMS OTHER THAN THOSE ALLOWED BY THE CODES MAY BE IN ACCORDANCE WITH SPECIFIC DESIGN PLANS PREPARED BY A NEW YORK STATE LICENSED PROFESSIONAL ENGINEER.
2. ALL TRENCH EXCAVATION AND ANY REQUIRED SHEETING AND SHORING SHALL BE DONE IN ACCORDANCE WITH THE LATEST REVISIONS OF THE FOLLOWING CODES:
 - A) SUBPART 23-4, "EXCAVATION OPERATIONS", OF NEW YORK STATE DEPARTMENT OF LABOR INDUSTRIAL CODE RULE 23.
 - B) SUBPART P, "EXCAVATIONS, TRENCHING AND SHORING", OF U.S. DEPARTMENT OF LABOR O.S.H.A. REGULATIONS FOR CONSTRUCTION.

THE MORE STRINGENT REQUIREMENT IN EACH CODE SHALL APPLY.

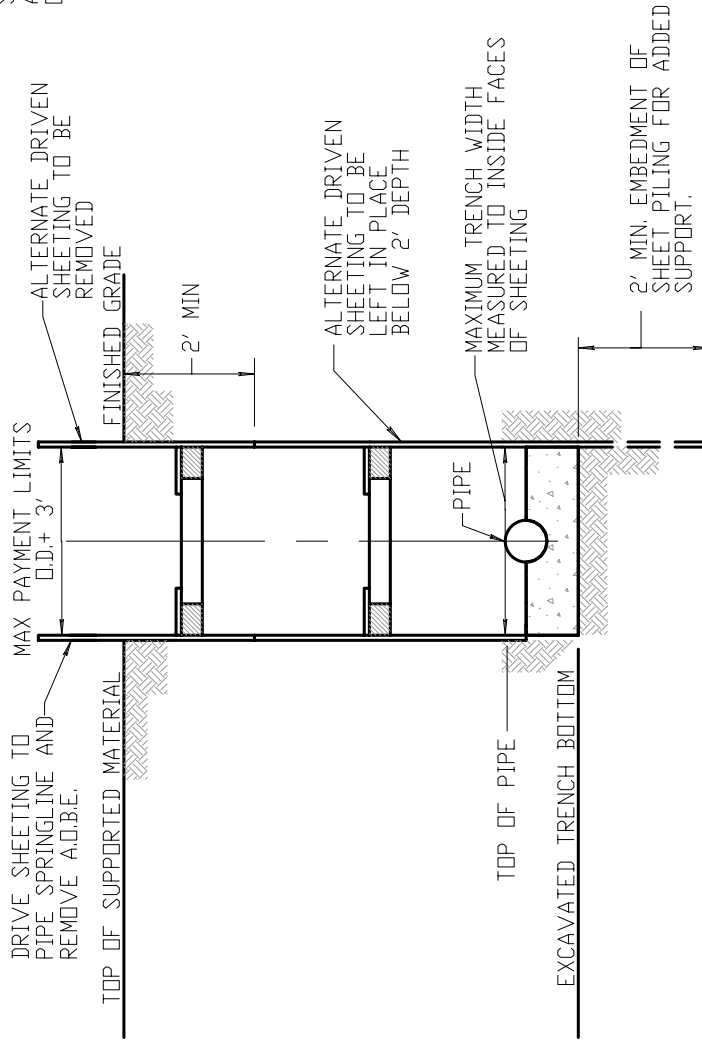

SHEETING SECTION

NOT TO SCALE